

WRICON

by Contract Connections



In a perfect world everyone would have a **PERFECT EARTH...**

...Now with **WRICON** they can!

NEW HEAVY DUTY WRICON..

NEW Solid copper lug at top end with 12mm thread. Larger and stronger than before.

Cadweld Connections for total penetration and permanence. All strands securely bonded to steel bar at the bottom and copper lug at the top.

All Wricons now have Tinned Centre lug



NOW AVAILABLE WITH 240mm² CABLE

all connections cadwelded

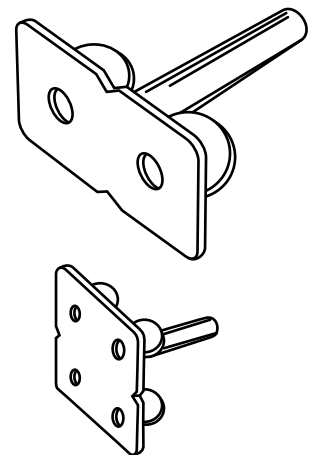
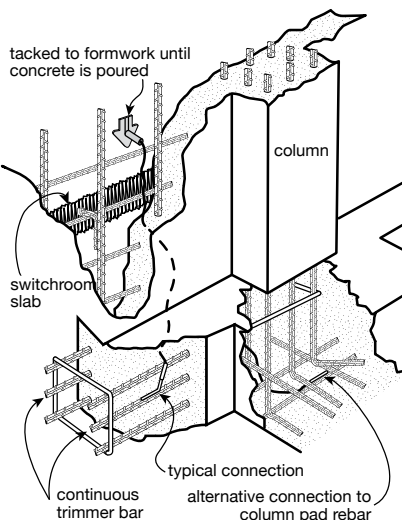
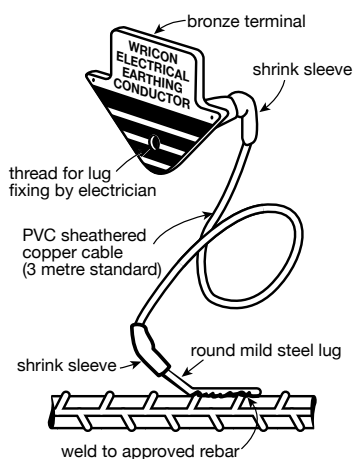

WRICONS ALSO AVAILABLE WITH 2 OR 4 HOLE TERMINAL



MANUFACTURED BY:

CONTRACT CONNECTIONS LTD
Phone: (09) 274 4049
www.contractconnections.co.nz



DISTRIBUTED BY:



TRANSNET NZ LIMITED
FREEPHONE: 0800 442 182
FREE FAX: 0800 442 183

EMAIL: sales@transnet.co.nz
WEBSITE: www.transnet.co.nz

EARTHING SYSTEMS - FOR ALL INSTALLATIONS

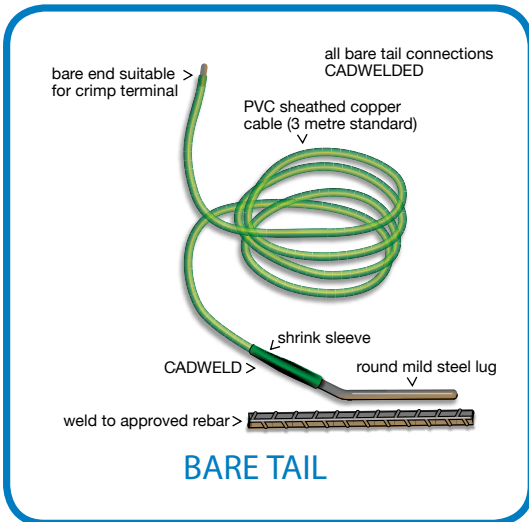
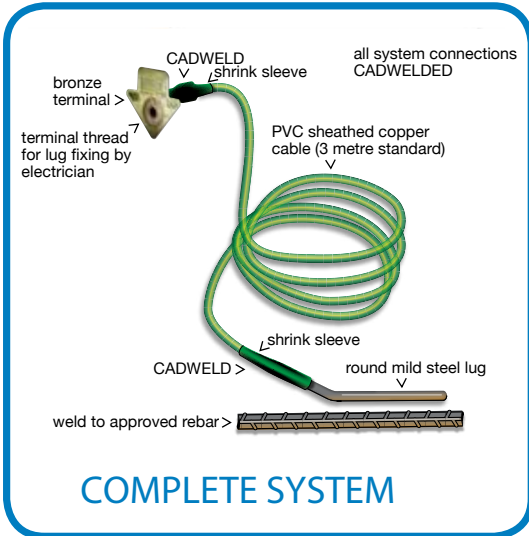

THE WRICON EARTHING SYSTEM provides the means to locate the entire system completely within the structure, thus providing a location away from any possibility of accidental damage or unauthorised disconnection.

Safe and effective electrical earthing is the essential requirement of all electrical installations, and the use of reinforced concrete foundations is an excellent method of achieving this aim.

The WRICON Earthing System permits the installation of an indestructible, totally reliable and constant electrical earth. The heart of the WRICON Earthing System is the unique Earthing Terminal Plate which allows earthing to the building frame (foundations or rebar) to be installed easily, simply and very professionally by any person who can weld proficiently. Earthing to the building frame (foundations or rebar) is permitted under the E.W.R. of New Zealand and the use of WRICON Earthing System has obvious advantages:-

1. Reinforcing steel in concrete foundations provides an indestructible earth electrode.
2. WRICON earth lead is safely cast within the concrete and cannot be severed by other trades digging for services and is also secure from theft.
3. CADWELD welded connections (unlike compression connections) do not deteriorate. Additionally the tinned solid copper head lug, bronze terminal plate and insulated earth lead incorporated in the WRICON Earthing System prevent galvanic corrosion and high resistance joints, permanently.
4. Lower resistance to earth than will be obtained by conventional methods and is much less subject to seasonal changes.

TYPE/CAT NO.	WRICON Cable	Mains Cable	1 Sec Current Rating	3 Sec Current Rating	Lug Diameter	Terminal Thread Size	Terminal Depth
TNC - 16	16mm ²	4mm ² - 50mm ²	2.3 KA	1.3 KA	10mm	M8	16mm
TNC - 35	35mm ²	70mm ² - 120mm ²	5.0 KA	2.9 KA	10mm	M8	16mm
TNC - 50	50mm ²	120mm ² - 150mm ²	7.1 KA	4.1 KA	16mm	M10	20mm
TNC - 70	70mm ²	150mm ² - 180mm ²	10 KA	5.8 KA	16mm	M10	20mm
TNC - 95	95mm ²	185mm ² - 240mm ²	13.6 KA	7.8 KA	16mm	M10	20mm
TNC - 120	120mm ²	240mm ² - 630mm ²	17.2 KA	9.9 KA	16mm	M10	20mm

SPECIAL NOTE:

- Installer to notify local supply authority for inspection of welded termination to rebar before concrete is poured.
- Suffix-BT depicts a bare tail Wricon.